

CURVED MENUBOARD

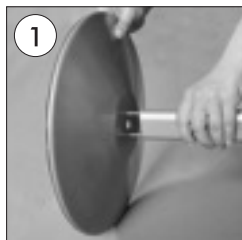

1
• Complete the stand by screwing the classical base to the ellips profile.

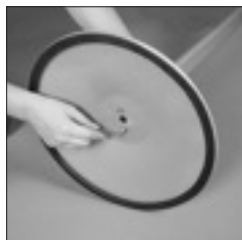

2
• Place the screw on the back of frame into hole on the pole. Screw the nut to fix the unit.



3
• Open all profiles.

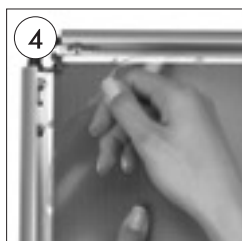

4
• Take-off the anti-reflex cover.



5
• Place the poster in.

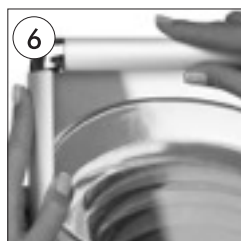

6
• After placing the cover back on the poster, close the profiles.

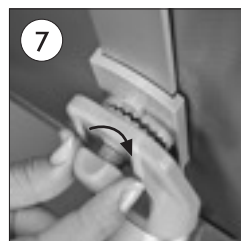

7
• Loose or tight the nut on the back of the frame in the direction of arrows. When loose, frame can be placed either portrait or landscape. Then tighten the nut to fix the frame position. The frame is made fixed when it is taken into the closed position.



Portrait

Landscape

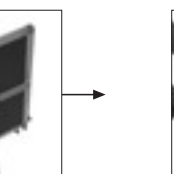
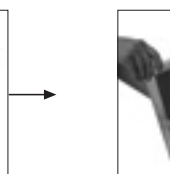
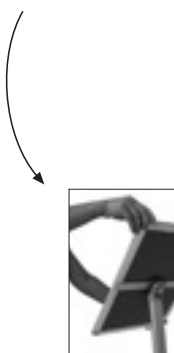

• Please inform the order number on the product or on the carton (e.g. 1/110001394-460) to the place that you have made the purchase if any problem with the product occurs.

• All rights reserved. All pictures, figures and writings are secured internationally by copy-right law. Infringements will be sued by civil and legal law.

1004950