

RAPID BROCHURE SET



• Screw and fasten the legs on the main body profile of the frame.



• Put the shelf through main body profile.

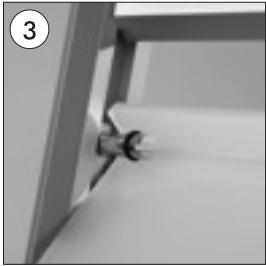

• Fix the short twisted part of the shelf on the edge pins.

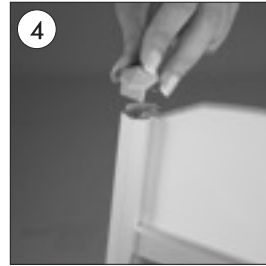

• Take off the end-caps from header part. Slide out 2 pieces of header from profile channels.



• Place your logo between 2 pieces of header. Slide-in the header part from profile channels.



• Place the end-caps on the header.
• Setzen Sie die Endkappen wieder auf die Seitenprofile
• Alınlık profili üzerindeki tapaları takın.



• Please inform the order number on the product or on the carton (e.g. 1/110001394-460) to the place that you have made the purchase if any problem with the product occurs.

• All rights reserved. All pictures, figures and writings are secured internationally by copy-right law. Infringements will be sued by civil and legal law.

1004893